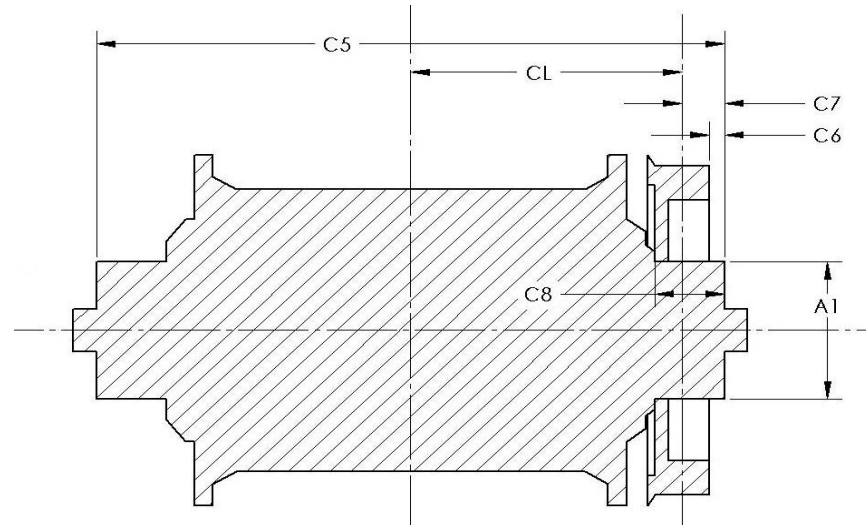

**main hubgear measurements**  
**GATES CARBON DRIVE**

 valid from December 11th. 2008  
 (all units metric - mm)

$$C6 = C8 - B1 - B3$$

$$C7 = C6 + C1/2$$

$$CL = C5/2 - C7$$

 Universal transmissions GMBH  
 Külfalstr. 18  
 31093 Lübbrechtsen  
 Germany  
 phone: (49)-5185-60266-50  
 info@carbondrive.net  
 www.carbondrive.net

(all units metric - mm); CL=Chainline(Beltline); subject to change without notice

manufacturer and description	C5	C6	C7	C8	CL	A1
Shimano Alfine SG - 500	135	16,2	22,85	24,5 - 24,7	44,65	34,7/3-Lobe
Shimano Nexus INTER3 SG - 3C41	120	12,25	17,5	18,0 - 18,3	42,5	34,7/3-Lobe
Shimano Nexus SG - 8R20	132	16,35	21,6	22,0 - 22,5	44,4	34,7/3-Lobe
Shimano Nexus SG - 8R25	128	16,35	21,6	22,0 - 22,5	42,4	34,7/3-Lobe
SRAM I-MOTION 3* NAF	130	16,25	21,5	21,3 - 23,0	43,5	34,7/3-Lobe
SRAM S7 NAF	128	11,45	16,7	16,3 - 18,4	47,3	34,7/3-Lobe
Rohloff 500/14	135	7	12,75	18,9 - 19,1	54,75	M34x6 P6
	nominal measurement	calulation (tolerance middle)	calulation (tolerance middle)	including production tolerance	calulation (tolerance middle)	nominal diameter